

**K9A : BODYSHELL**

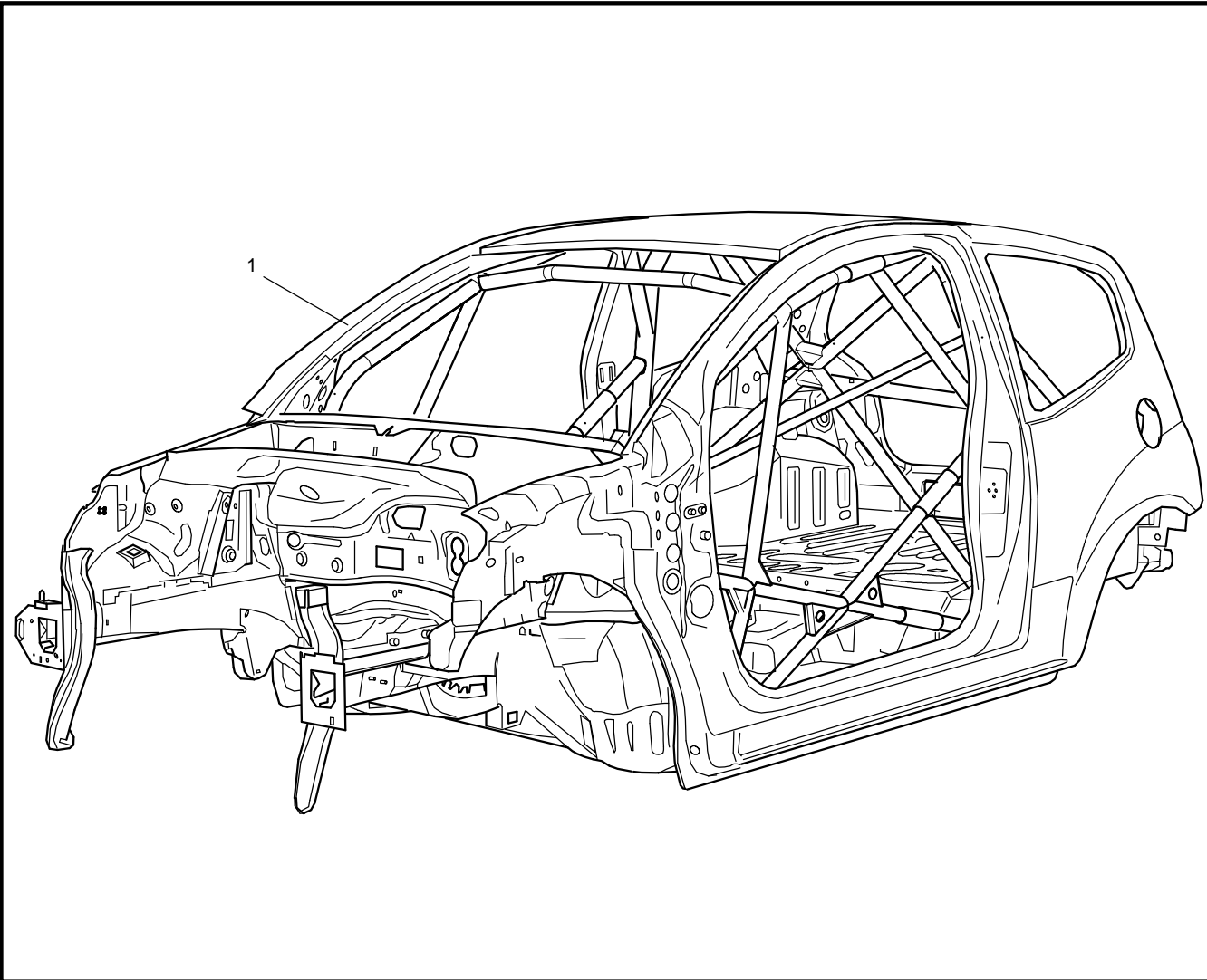

REF	PART NUMBER	QTY	DESCRIPTION
1	2K9A61314B	1	Welded bodyshell with roll cage
2			
3			
4			
5			
6			
7			
8			
9			
10			
11			
12			
13			
14			
15			

**BODYSHELL INFORMATIONS**

**!!!**

**It is not allowed by F.I.A regulations (J Annex) to do any modifications on the roll cage.**

**The roll cage has to stay original.**

**K9A : TUNNEL REINFORCEMENT**

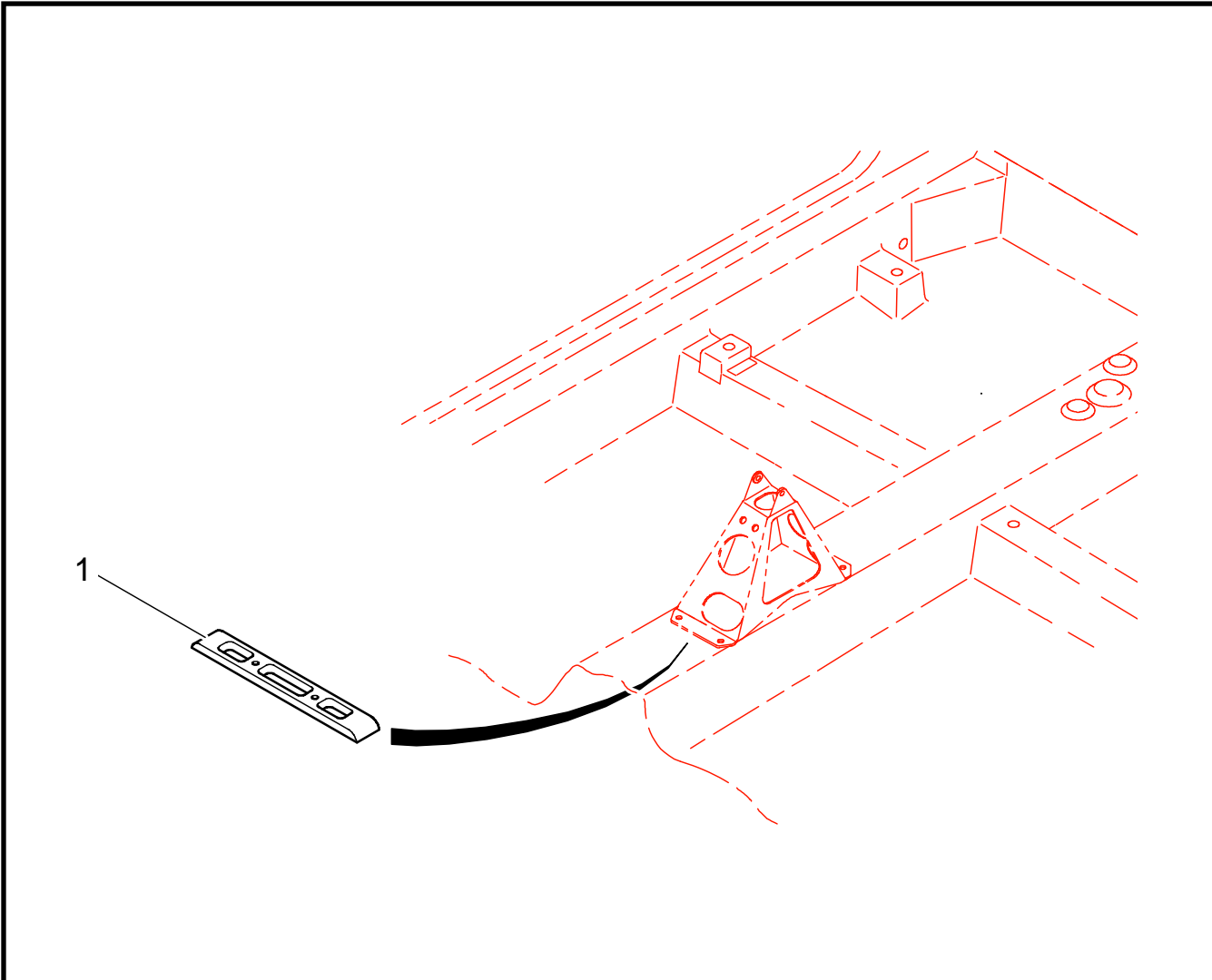

REF	PART NUMBER	QTY	DESCRIPTION
1	2K9A62553A	1	Tunnel reinforcement
2			
3			
4			
5			
6			
7			
8			
9			
10			
11			
12			
13			
14			
15			

## **TUNNEL REINFORCEMENT ASSEMBLY**

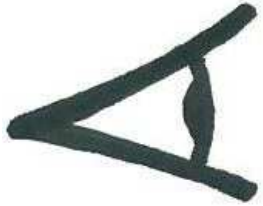

Check or download « **Controls G21 Gearbox control** » in **G** Chapter to know where and how weld the tunnel reinforcement on the body.

**K9A : ROOF VENT**

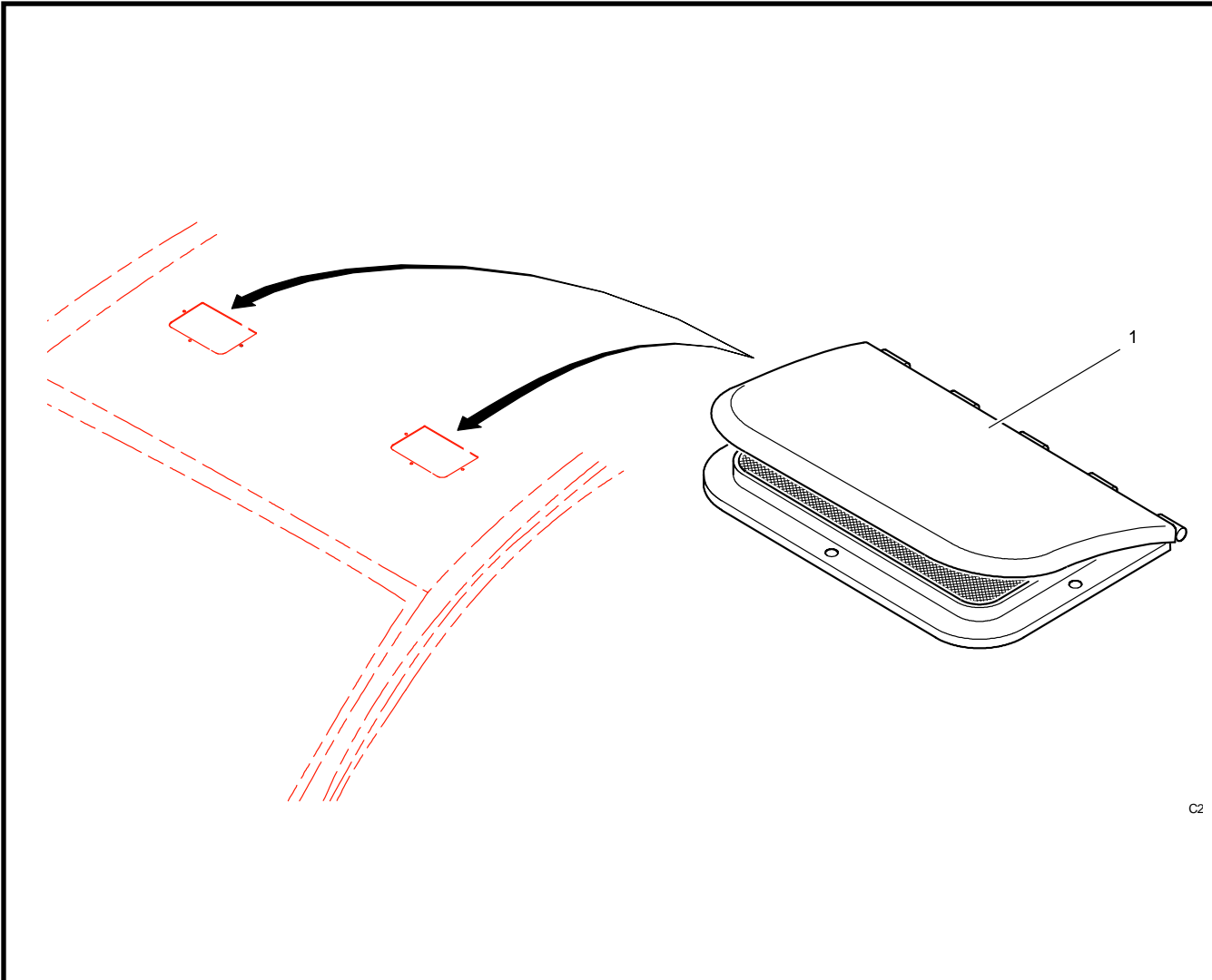

REF	PART NUMBER	QTY	DESCRIPTION
1	2K9A21793A	1	Roof vent
2			
3			
4			
5			
6			
7			
8			
9			
10			
11			
12			
13			
14			
15			

**SUPER 1600 ROOF VENT**

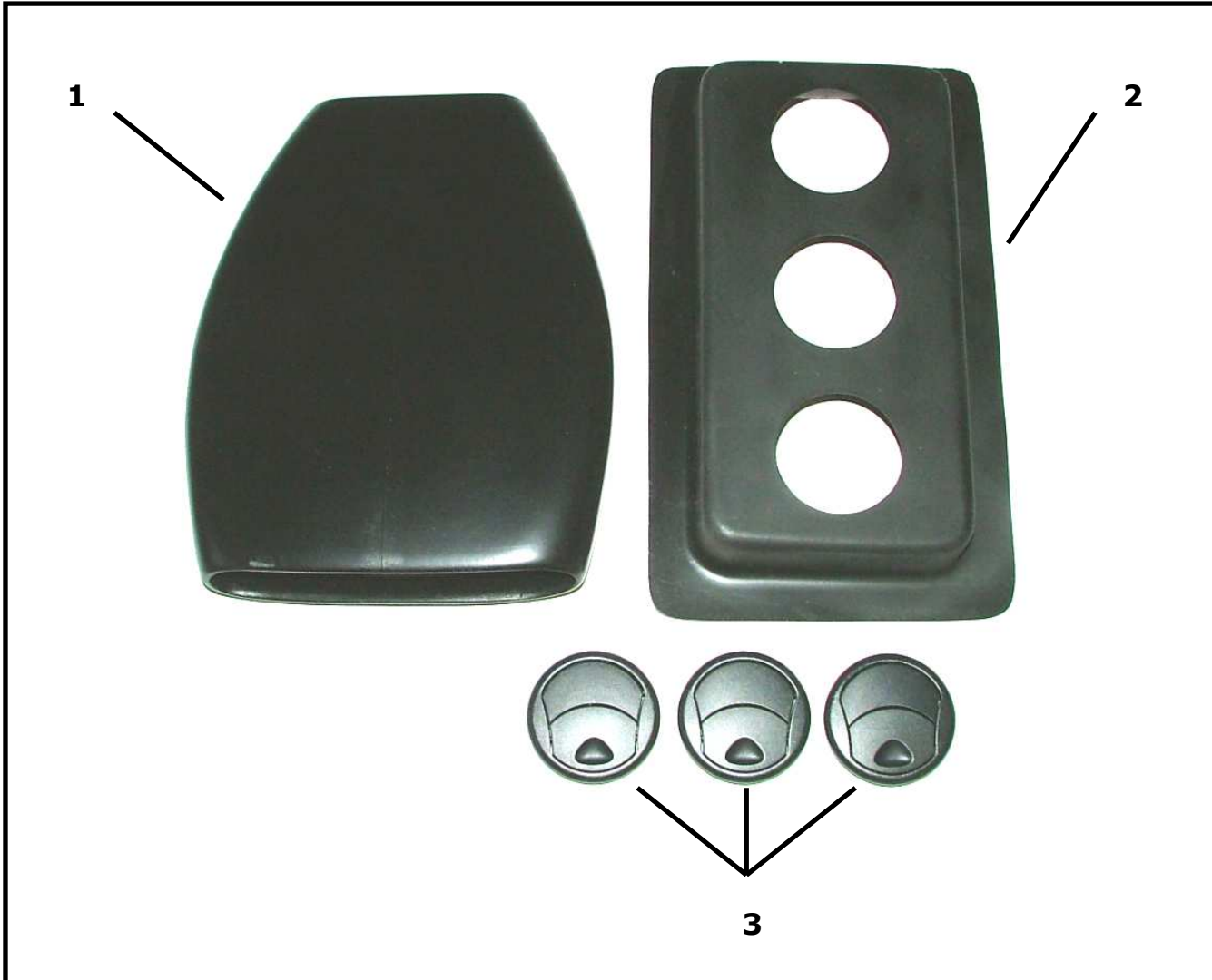

REF	PART NUMBER	QTY	DESCRIPTION
1	3V1B60328A	1	Roof air vent
2	3V1B60329A	1	Inside air diffuser
3	3V1B41961A	3	Sensyo air jet
4			
5			
6			
7			
8			
9			
10			
11			
12			
13			
14			
15			

**SUPER 1600 ROOF VENT ASSEMBLY**

A

**Cut off a square in the roof (120 x 120),  
at air vent location.**

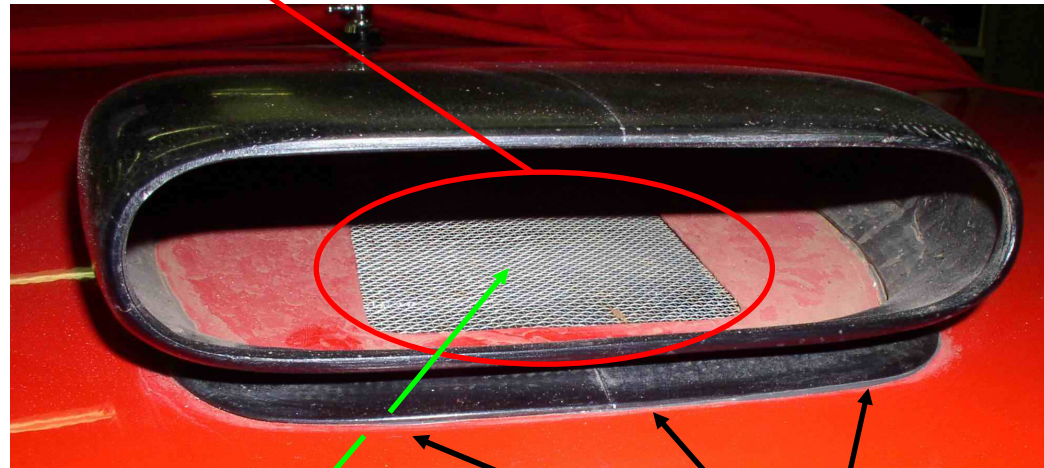

**Stick a piece of mesh with  
bicomponent 3M 490 glue.**

**Stick the air roof vent with  
Bicomponent 3M 490 glue.**

**Seal all around the roof air vent  
with silicone.**

A

Stick the air diffuser on the roof, with bi component 3M 490 glue and seal it all around with silicone.

Fit air jets to the diffuser.

