

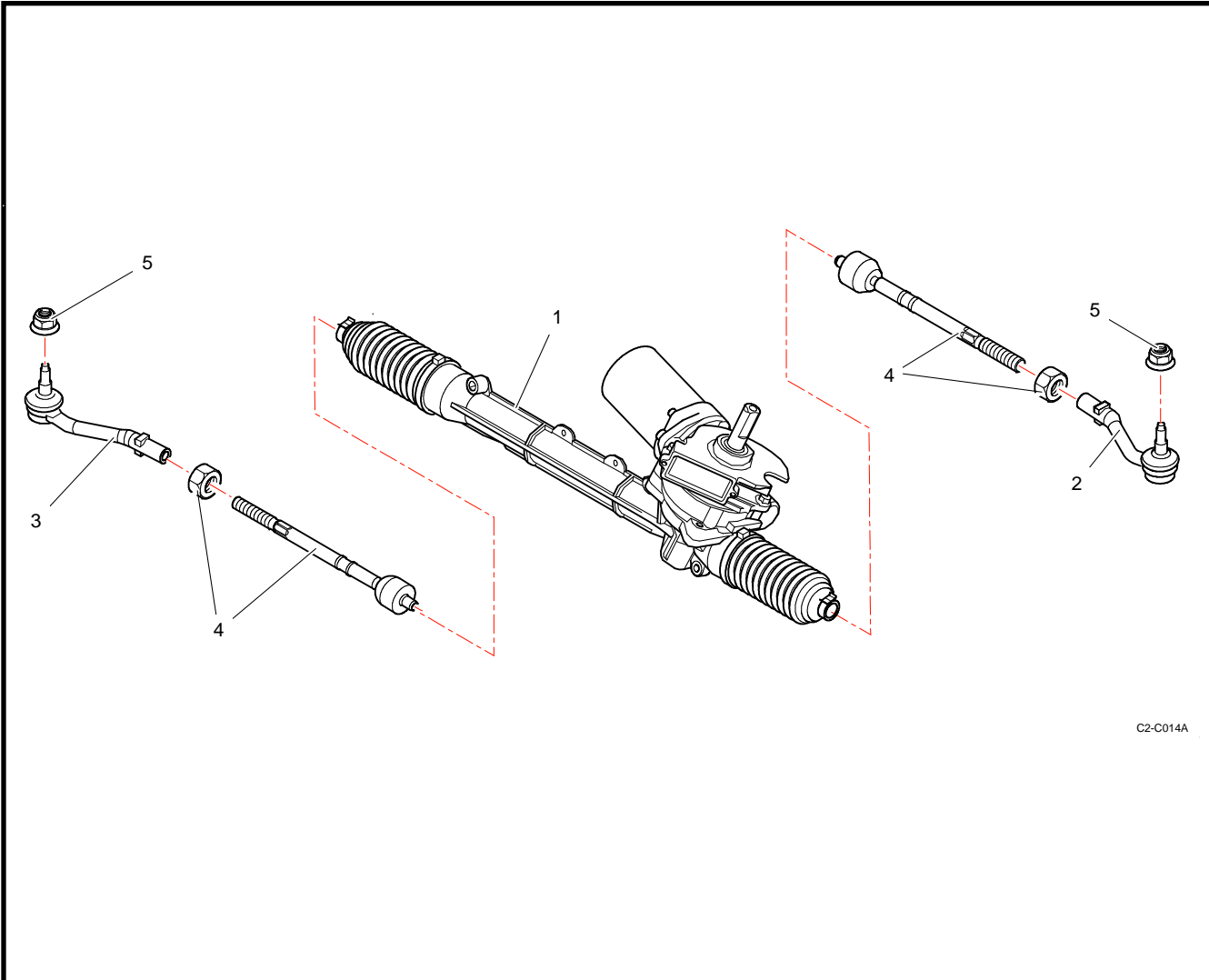

E44 : RACK (For GT)



REF	PART NUMBER	QTY	DESCRIPTION
1	BCSP4000NV	1	Steering rack
2	1E4461183B	1	Left steering ball joint assembly
3	1E4461182B	1	Right steering ball joint assembly
4	1E4461181B	2	Steering arm
5	BCSP693942	2	Steering ball joint self locking nut
6			
7			
8			
9			
10			
11			
12			
13			
14			
15			

RACK ASSEMBLY

	<p>Steering link / rack torque</p>	<p>5 m.kg + Loctite 242</p>
	<p>Steering ball joint / front up-right torque</p>	<p>3.5 m.kg</p>
<p>!!!</p>	<p>On tarmac but more often on gravel, a steering arm can be bent after a wheel schock with a big stone or something else. On the service, you absolutely need to change it, otherwise it will break the schock after.</p> <p>When a steering arm is broken, the wheel angle is too big, and the driveshaft is not able to support it. You need to check the driveshaft, or the best is to change it.</p>	